

Homerit Recessed Window Installation Guide v1.0

Preparation:

- Install 45mm high setback timber packer on bottom timber frame 20mm behind exterior surface of RAB board, or 20mm behind exterior surface of timber frame if there is no RAB board.
- Install flashing tape over setback timber packer and bottom timber frame. Refer photo 1.
- Read installation drawing, check cladding type to make sure head, sill & jamb flashing sizes are correct.



Photo 1

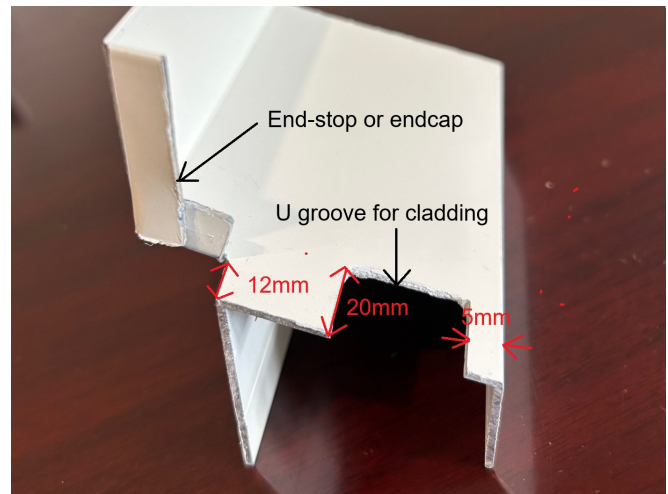

Photo 2

Install sill flashing:

- Cut sill flashing 34mm longer than the width of the window frame. Cut and fold 12mm as end-stops at each end so that the back part of the sill flashing can be placed into the timber frames. Or use end caps instead of folded end-stops. Cut 20mm deep U-groove 5mm from the front edge of sill flashing for cladding boards at each end. Refer photo 2. U-groove is not needed for brick veneer cladding or head & jamb flashings are behind cladding.
- Install sill flashing temporarily using two screws, 150mm from each end. Install flashing tap to seal the gap between sill flashing and set back timber pack.

Install jamb flashings if they were not fitted in the factory:

- Cut jamb flashings 57mm(J1)/52mm(J2)/45mm(J3) longer than the height of the window frame (not including the flange at the bottom, including flange at top for bifold window or door). Cut bottom end at 15-degree slope.
- Fit jamb flashings into the grooves of the window frame on both sides at the outside edge, 10mm lower than the top frame, use self-drilling screws, 50 to 100mm from each end, then 450mm centres thereafter. Note: drill straight, drilling at an angle may damage the uPVC frame surface. Refer photo 3.

Install window frame:

- 40mm x 8g stainless steel screws for securing fixing brackets.
- Minimum 90mm x 10g pan-head stainless steel screws for securing uPVC frames, 150mm from corners, then 450mm centres thereafter. Pre-drill through steel reinforcements as required if not pre-drilled yet. Safety stays need to be released temporarily for access, then fit back after installation. Refer Photo 4.

- Pack each fixing point. After fixing remove the packers from the head of the unit.



Photo 3



Photo 4

Install head flashing:

- Cut head flashing 34mm longer than the width of window frame if there are no scribes. Add another 100mm if scribes are required. Fit gasket into head flashing for Very High wind zone or above.
- Fix head flashing on top of jamb flashings, 150mm from each end, then 450mm centres thereafter. Fit end caps at both ends. Refer photo 5.

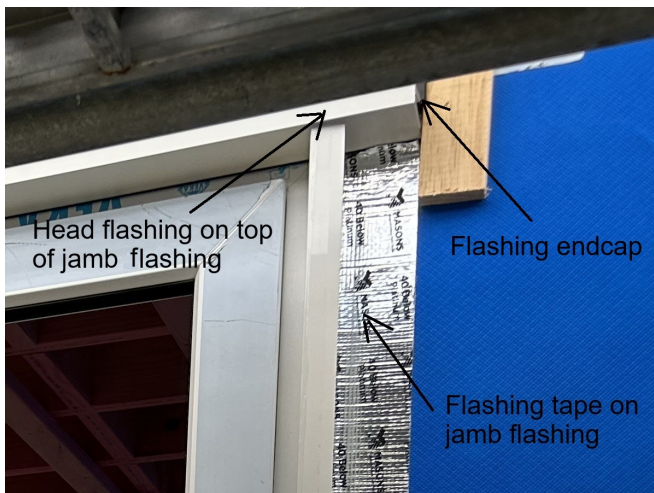

Photo 5



Photo 6

Adjust sill flashing:

- Adjust height to be tight with jamb flashings, fix 150mm from both ends, then 450mm centres thereafter. Refer photo 6.

Flashing tapes and air seal:

- Install flashing tapes at jamb flashing first, then at head flashing. Refer photo 5.
- Apply PEF backing rod and foam seal around the unit from the inside.